

# Rylee H at 18107 73 St NW

BED	BATH	SQ FT	HOME STYLE
3	2.5	1989	FRONT ATTACHED GARAGE HOME

GARAGE TYPE  
DOUBLE ATTACHED



BLOCK: 21

STAGE: 21A

LOT: 37

JOB: CSA-0-035539

COMMUNITY



SHOWHOME  
ADDRESS  
18004 - 70th Street  
NW

SHOWHOME  
HOURS

Monday - Thursday  
from 3 - 8PM  
Weekend and  
Holidays  
from 12 - 5PM

CONTACT

Mohammad  
Ghounash  
587-570-5471

# Model Features

- This 3 bedrooms, 2.5 bathrooms home backs onto a park
- Massive walk through pantry
- Expansive primary bedroom
- 50" Linear Ortech LED electric fireplace
- 41" Kitchen upper cabinets to the ceiling
- 4 piece Samsung stainless steel kitchen appliances
- Ensuite bath comes with dual sinks and a standing shower with tiled walls
- Paint grade railing with straight metal spindles
- Luxury vinyl plank in the main floor and second floor bathrooms and laundry
- Quartz countertops throughout
- This Bedrock Homes include a modern smart home technology systems (Smart Home Hub), Eco bee thermostat, video doorbell & Weiser Halo Wifi Smart keyless lock with touch screen
- Second floor laundry for convenience
- LED pot lights throughout

## Floor Plans

MAIN FLOOR



SECOND FLOOR

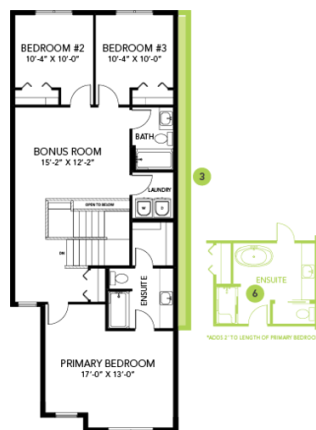

LEGAL BASEMENT SUITE

