

Stella P at 3670 5A AVE SW

Get Cash Back

BED	BATH	SQ FT	HOME STYLE
4	3	1833	FRONT ATTACHED GARAGE HOME

GARAGE TYPE

DOUBLE ATTACHED



QUICK POSSESSION

BLOCK:	15	STAGE:	32B
LOT:	29	JOB:	CHH-0-035446

COMMUNITY



SHOWHOME ADDRESS

Single Family Home with Front Attached Garage
328 – 40 Street SW

Single Family Home with Rear Detached Garage
268 Charlesworth Drive SW

SHOWHOME HOURS

Monday - Thursday from 3 - 8PM
Weekend and Holidays from 12 - 5PM

CONTACT

Brian Tate
587.521.5869

Model Features

- Located on a corner lot, thus you have a bigger backyard and extra windows in your house!
- Built with a main floor bedroom and full bathroom, spacious living room, dinette, and central kitchen with a walk-through pantry, and 41" soft close upper cabinets.

- Every Bedrock home comes complete with a modern smart home technology system (Smart Home Hub), Ecobee thermostat, Ring video doorbell & Weiser Halo Wi-Fi Smart keyless lock with touch screen.
- Side entry is added for a future legal suite; The basement ceilings are upgraded to 9'.
- Spindle railing on the stairs and upper hall to create an open feel from main floor to upper level.
- Built with a 4-piece ensuite with upgraded stand-up shower and dual sinks.
- Double compartment stainless steel under mount kitchen sink, complete with a chrome finish faucet with pull down sprayer, and 1.5gpm aerator.
- All Bedrock homes include a complete appliance package that includes: Stainless Steel kitchen appliances including a 28 cu. Ft. French door fridge with bottom pull out freezer and ice machine, a 5 burner range, an OTR microwave and a built-in dishwasher.
- The Laundry is high efficiency front load washer and dryer in white.
- North facing backyard.
- Energy efficient features include triple pane, Low-E, argon gas filled, Energy Star rated windows, heat recovery ventilator, 96.5% efficient and direct vented furnace, 80gal hot water tank and Bedrock's "Hotbox" system.
- Quartz counters in the kitchen and all bathrooms.
- Luxury Vinyl Plank flooring throughout the main floor and all "wet" areas.
- Advanced wear and stain protection carpet w/ 35 oz. weight and 8 lbs. under pad.
- Painted basement floor and the removable 5' x 2' dual slider.
- Basement windows are wide enough to fit drywall through for future basement development.
- Includes community address plaque.
- All ductwork is cleaned prior to moving in.

Floor Plans

MAIN FLOOR



SECOND FLOOR

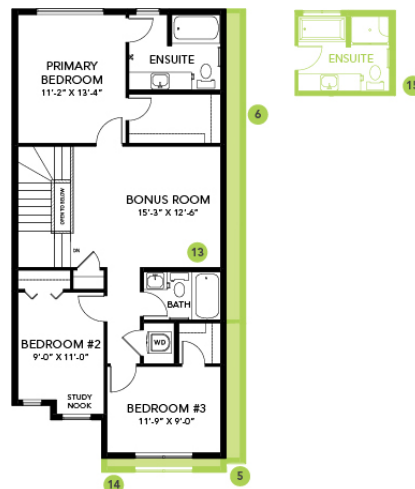

LEGAL BASEMENT SUITE

