

Ruby B at 7 Ashbury Crescent

Get Cash Back

BED	BATH	SQ FT	HOME STYLE
3	2.5	1928	FRONT ATTACHED GARAGE HOME

GARAGE TYPE

DOUBLE ATTACHED



BLOCK:	31	LOT:	4
STAGE:	12	JOB:	JSP-0-035485

COMMUNITY



SHOWHOME
ADDRESS

3 Ashbury Crescent

SHOWHOME
HOURS

Monday - Thursday
from 3 - 8PM
Weekend and
Holidays
from 12 - 5PM

CONTACT

Mike Marsh
587.802.1334

Model Features

- Steps from parks and running trails
- Direct access to laundry room from the primary bedroom
- 3 Bedrooms, 2.5 bathrooms and a bonus room upstairs

- 18 x 22 Attached double car garage
- Corner kitchen with large square island
- 9' Ceilings on Main floor
- 6-piece Samsung Stainless Steel Appliances with white high efficiency front load washer/dryer
- Upgraded kitchen backsplash
- Dual sinks in ensuite
- LED pot lights throughout
- Upgraded Siding to a premium colour
- Electric Fireplace in the great room
- Paint Grade Railing with straight metal spindles
- Luxury vinyl plank throughout
- Quartz throughout
- Smart home package
- Upstairs laundry
- Upgraded overhead garage door
- 41" Kitchen upper cabinets
- Heat recovery ventilator
- Triple pane, Low-E argon filled Energy Star rated windows
- Over \$15K in included designer options.

Floor Plans

MAIN FLOOR



SECOND FLOOR

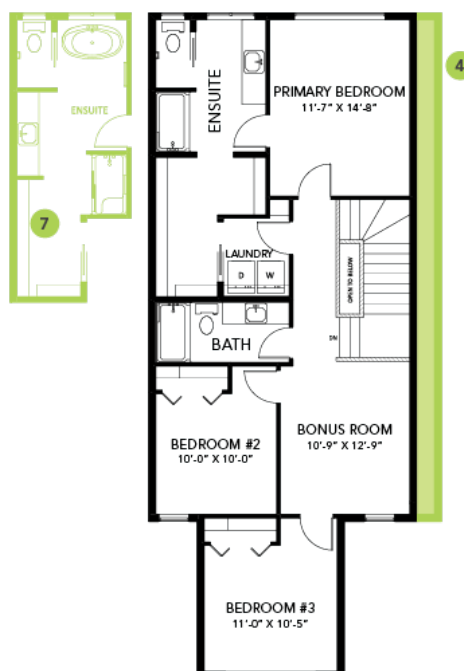

LEGAL BASEMENT SUITE

