

# Seville K

2002 SQ FT

2922 Kostash Drive SW



### One at Keswick Showhome

2910 Kostash Drive SW, Edmonton AB.

780.761.2211

oneatkeswicksales@bedrockhomes.ca

Job # KWK-0-033656 Lot 7 Block 9, Plan 152-3091

- 2 storey, 3 bedroom home with vaulted ceiling bonus room
- 2nd floor laundry room
- Upgraded 4 piece ensuite includes: 72" corner soaker, 48" fully tiled shower with 5 mil sliding glass shower door and double sinks
- Maple Kitchen Craft cabinets in Espresso
- Assiniboine maple matte hardwood flooring
- 12" x 24" Mocha tile in mudroom, main bath and ensuite
- Quartz countertops in kitchen, main bath and ensuite
- Glass tile backsplash in Vogue taupe strips
- 41" high upper cabinets and pots & pans drawers in kitchen
- Sidewall cantilevered fireplace
- Premium range light package
- Kohler Alteo faucets with Bellera
- Black railing with metal spindles on main and second floor
- Oversized 8' patio door
- 9' main floor
- 21' x 22' / 33' tandem garage
- 35 year shingles
- Triple pane low E argon filled Energy Star rated windows
- Garage foundation poured full depth as basement
- Waterproof spray on foundation
- Sage siding with Aztec trim and cobble stone accent
- Black river stacked stone
- Accommodated for future rough in of 30" Chimney Hood Fan
- Gas line for BBQ
- 368.55 sq. m lot with a west facing backyard
- Premium 2 Package

### Notes:

---

---

---

---

---

---

---

---

[bedrockhomes.ca](http://bedrockhomes.ca)

VISIT US AT ANY OF OUR SHOWHOMES!

Monday - Thursday 3-8pm, Weekends & Holidays 12-5PM



# Seville K

2002 SQ FT

2922 Kostash Drive SW



## One at Keswick Showhome

2910 Kostash Drive SW, Edmonton AB.

780.761.2211

oneatkeswicksales@bedrockhomes.ca

Job # KWK-0-033656 Lot 7 Block 9, Plan 152-3091

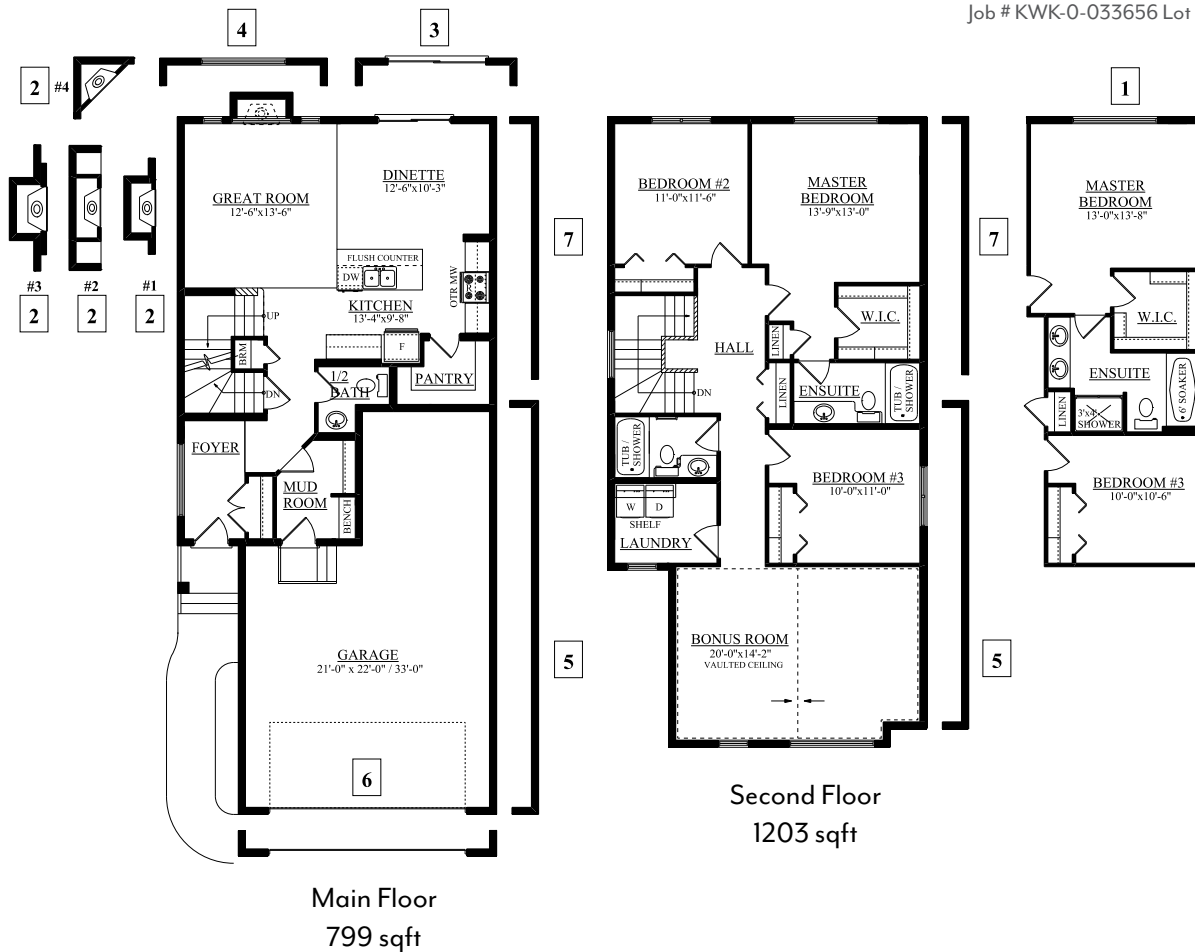

[bedrockhomes.ca](http://bedrockhomes.ca)

VISIT US AT ANY OF OUR SHOWHOMES!

Monday - Thursday 3-8pm, Weekends & Holidays 12-5PM

